

ABSTRACT OF LESSEES			
LOT	NAME	S.M.	ACRES
123-4	JESUS L.G. CRUZ	4,046	1

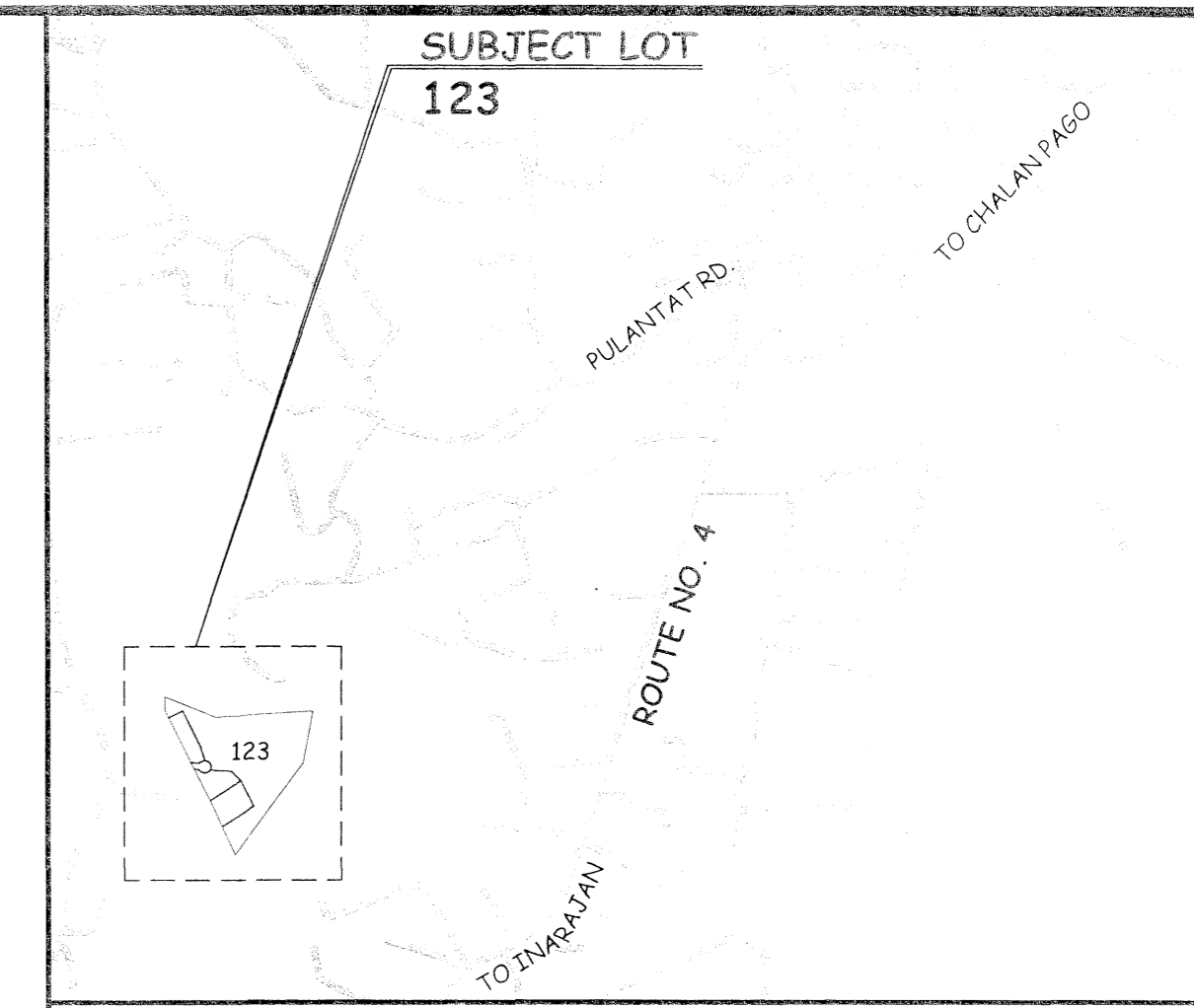
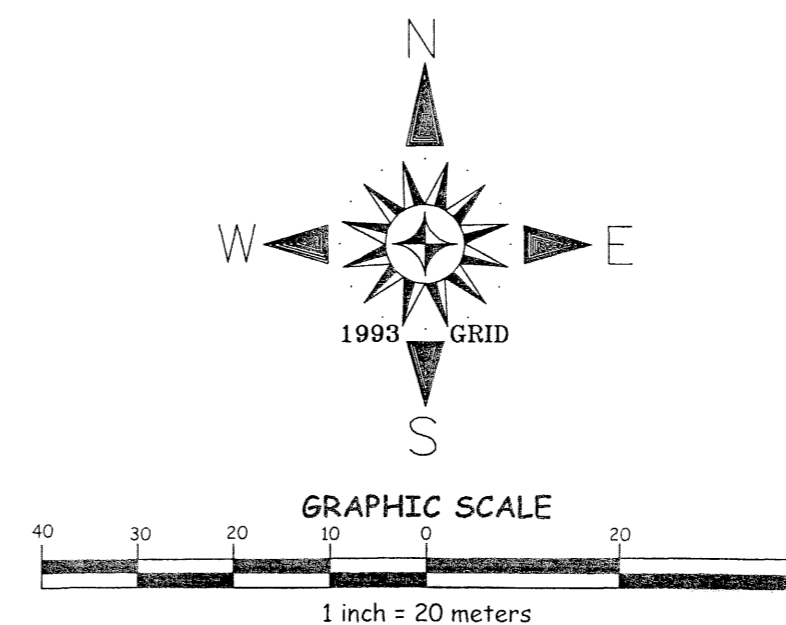
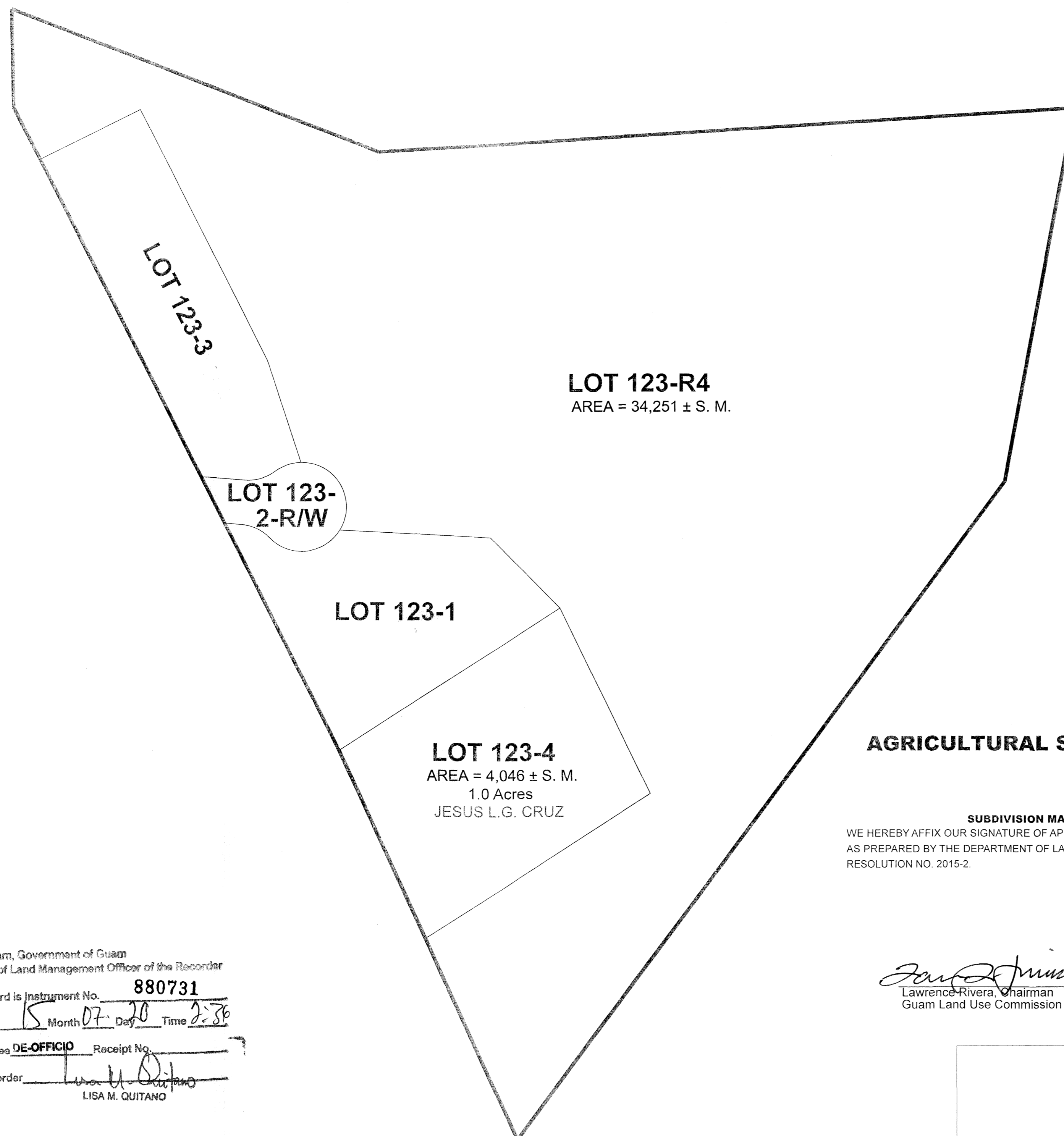

VICINITY MAP
NOT TO SCALE

SPECIAL NOTES:

- THIS PLAT WAS PREPARED FOR THE USE OF THE DEPARTMENT OF LAND MANAGEMENT, CHAMORRO LAND TRUST COMMISSION AND THE DEPARTMENT OF REVENUE AND TAXATION.
- THIS SUBDIVISION WAS PREPARED FROM RECORD DATA SOLELY, NO SURVEY FIELD WORK WAS UNDERTAKEN TO PREPARE THIS PLAT.
- THIS PLAT IS TO BE USED FOR PLANNING AND REAL PROPERTY ASSESSMENT PER SECTION 75108 FOR LOCATION PURPOSES ONLY, BUT IS NOT SURVEY ACCURATE.
SECTION 75108 CONDITION IN LEASES:
(f) THE LESSEE SHALL PAY ALL TAXES ASSESSED UPON THE TRACT AND IMPROVEMENTS THEREON.
- PROPERTY DATA, INCLUDING LOT NUMBERS AND CONFIGURATIONS ARE SUBJECT TO CHANGES OR REVISIONS UPON DETERMINATION OF TOPOGRAPHIC AND NATURAL OR MANMADE CONSTRAINTS.
- THIS PLAT WAS PREPARED PURSUANT TO TITLE 21, GUAM CODE ANNOTATED, CHAPTER 75 CHAMORRO LAND TRUST COMMISSION SECTION 75103(d) AND (e).
(d) THE COMMISSION IS AUTHORIZED TO CARRY ON ANY ACTIVITIES IT DEEMS NECESSARY TO ASSIST LESSEES IN OBTAINING MAXIMUM UTILIZATION OF LEASED LANDS, INCLUDING ANY STEPS NECESSARY TO DEVELOP THESE LANDS FOR THEIR HIGHEST AND BEST USE COMMENSURATE WITH THE PURPOSE FOR WHICH THE LAND IS BEING LEASED AS PROVIDED FOR IN SECTION 75107 AND ASSISTING LESSEES IN ALL PHASES OF FARMING AND RANCHING OPERATIONS AND THE MARKETING OF THEIR AGRICULTURAL PRODUCE AND LIVESTOCK.
(e) THE COMMISSION MAY DESIGNATE AND PLAN SUBDIVISIONS IN ACCORDANCE WITH THE PROVISIONS OF CHAPTER 62 OF THIS TITLE 21 G.C.A. ON AVAILABLE LANDS IN, ADJACENT TO, OR NEAR ANY VILLAGE.

REFERENCE:

- DWG. NO. 14-85T247, L.M. NO. 137 FY85, LAND REGISTRATION SURVEY MAP OF LOT 123 & 124, PREPARED BY DEPARTMENT OF LAND MANAGEMENT, UNDOCUMENTED.

REVIEWED BY:
LAND ADMINISTRATOR
 MARGARITA V. BORJA
 LAND MANAGEMENT ADMINISTRATOR
 DATE: 7-17-15

GUAM CHIEF PLANNER
 MARVIN Q. AGUILAR
 GUAM CHIEF PLANNER
 DATE: 7-17-15

CHIEF OF CADASTRE/GUAM CHIEF SURVEYOR
 PAUL L. SANTOS
 PROFESSIONAL LAND SURVEYOR NO. 68
 DATE: 7-17-15

AGRICULTURAL SUBDIVISION MASTER PLAN

OF LOT 123

MUNICIPALITY OF YONA

SUBDIVISION MASTER PLAN NO. 2015- M14-4

WE HEREBY AFFIX OUR SIGNATURE OF APPROVAL OF THIS AGRICULTURAL SUBDIVISION MASTER PLAN MAP AS PREPARED BY THE DEPARTMENT OF LAND MANAGEMENT PURSUANT TO GUAM LAND USE COMMISSION RESOLUTION NO. 2015-2.

Lawrence Rivera, Chairman Date 7/17/15
 Guam Land Use Commission

David J. Mantanane, Chairman Date 7/17/15
 Chamorro Land Trust Commission

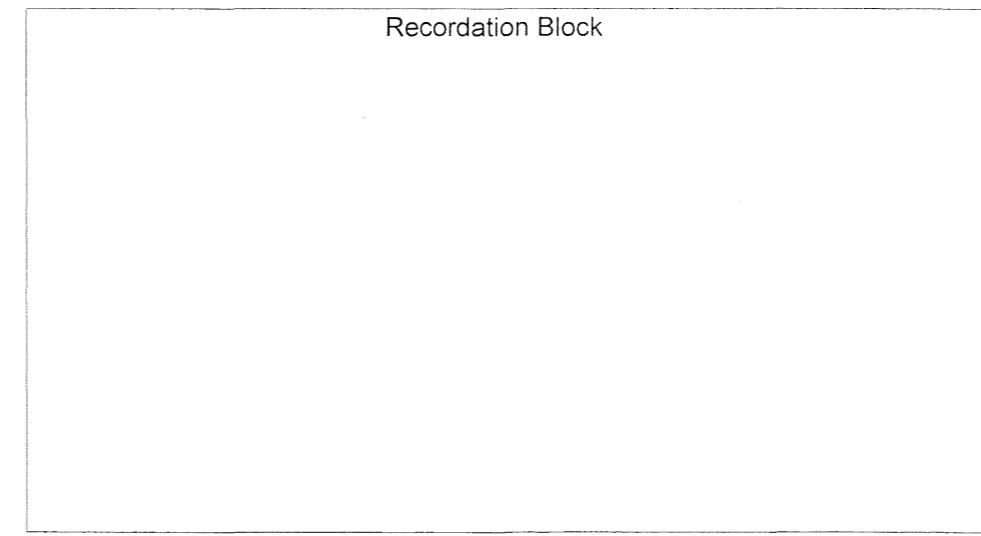

Island of Guam, Government of Guam
 Department of Land Management Officer of the Recorder

File for Record is Instrument No. **880731**

On the Year 15 Month 07 Day 20 Time 2:30

Recording Fee **DE-OFFICIO** Receipt No.

Deputy Recorder LISA M. QUITANO

NOTES:

- WATER AND POWER ARE WITHIN THE SUBDIVISION.
- SUBJECT LOT IS ZONED "A" (RURAL AGRICULTURAL)
- SUBJECT LOT IS OUTSIDE THE GUAM WATER SOURCE RECHARGE AREA

KUMISION INANGOKKON TANO' CHAMORU
 CHAMORRO LAND TRUST COMMISSION

AGRICULTURAL SUBDIVISION MASTER PLAN

OF LOT 123

LAND SQUARE 26 MUNICIPALITY OF YONA SECTION 3

SURVEY DATA		BASIC LOT DATA	
JOB NO. 2213-11-14	DATE	LOT	123
COMPUTED BY SURVEY	OCT.-DEC. 14	CERTIFICATE OF TITLE NO.	N/A
DRAWN BY SURVEY	JAN.-MAR. 15	REGISTERED ON:	UNREGISTERED
RESEARCHED BY SURVEY	OCT.-DEC. 14	ESTATE NO.	N/A
FIELD BY	-N/A-	IN THE NAME OF:	
REVIEWED BY	PLS APRIL 2015		
SCALE IS IN METRIC SYSTEM AS SHOWN			
SHEET 1 OF 1			GOVERNMENT OF GUAM
DWG. NO. 2213-11-14			
GRID: D4			

GOVERNMENT OF GUAM
 GUBETNAMENTON GUAHAN
 DEPARTMENT OF LAND MANAGEMENT
 DIPATAMENTON MINANEHAN TANO'
 LAND SURVEY DIVISION
 DIBISION AGRAMENSIAN TANO'